

Section IV

Exhibit "D": Zoning Vicinity Map
Exhibit "E": Existing Conditions Map

Application No. 4648



Proposed Rezoning
From: PRV, PUD 531 To: T-M-U/wvrs.

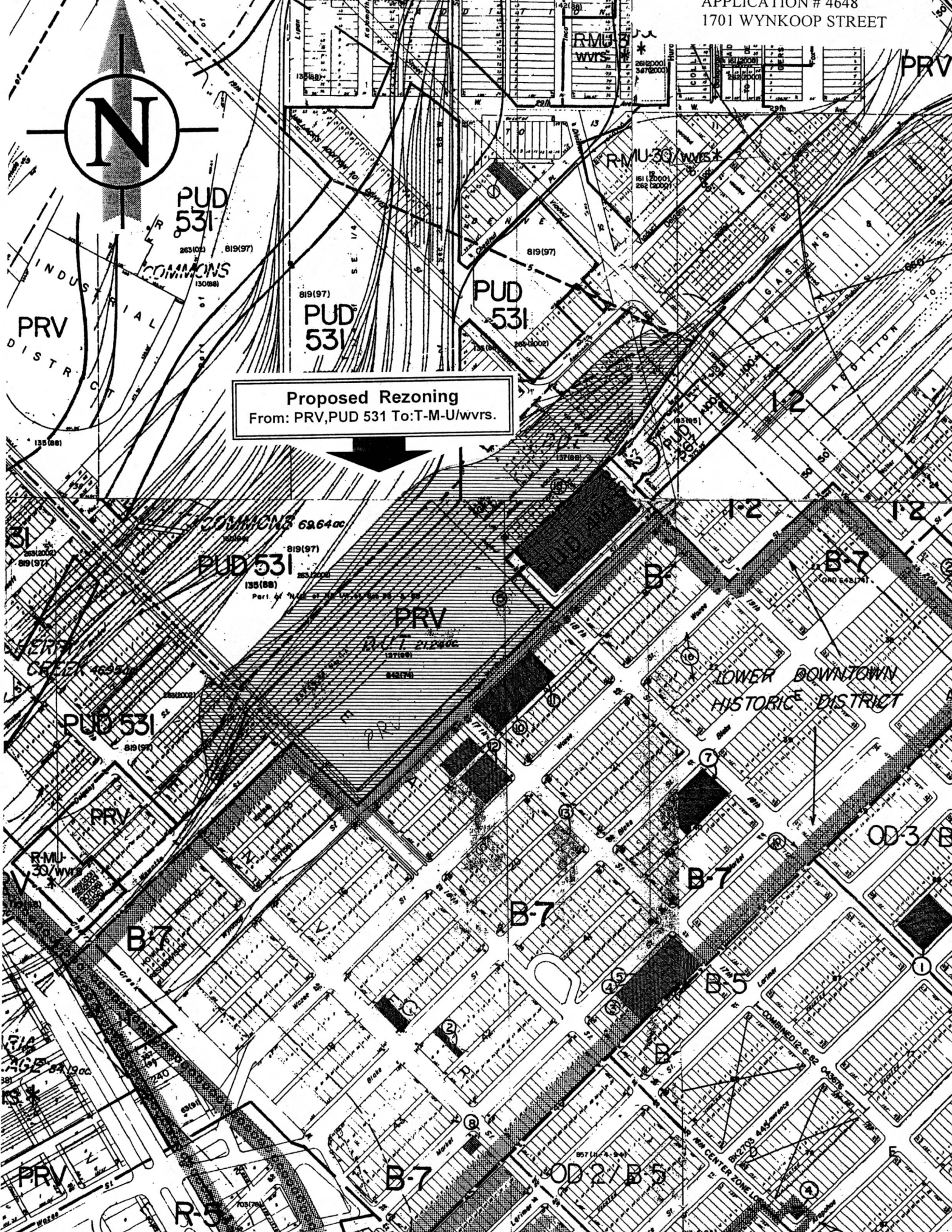

INDUSTRIAL COMMONS
PRV DISTRICT
PUD 531
819(97)
263(00)
135(08)

PUD 531
819(97)
263(00)
135(08)

PRV
PUD 531
819(97)
263(00)
135(08)

PUD 531
819(97)
263(00)
135(08)

PRV
819(97)
263(00)
135(08)

B-7
B-5
OD 3/B
OD 2/B 5
LOWER DOWNTOWN HISTORIC DISTRICT

PRV
PUD 531
819(97)
263(00)
135(08)

B-7
819(97)
263(00)
135(08)

B-7
B-5
OD 3/B
OD 2/B 5
LOWER DOWNTOWN HISTORIC DISTRICT

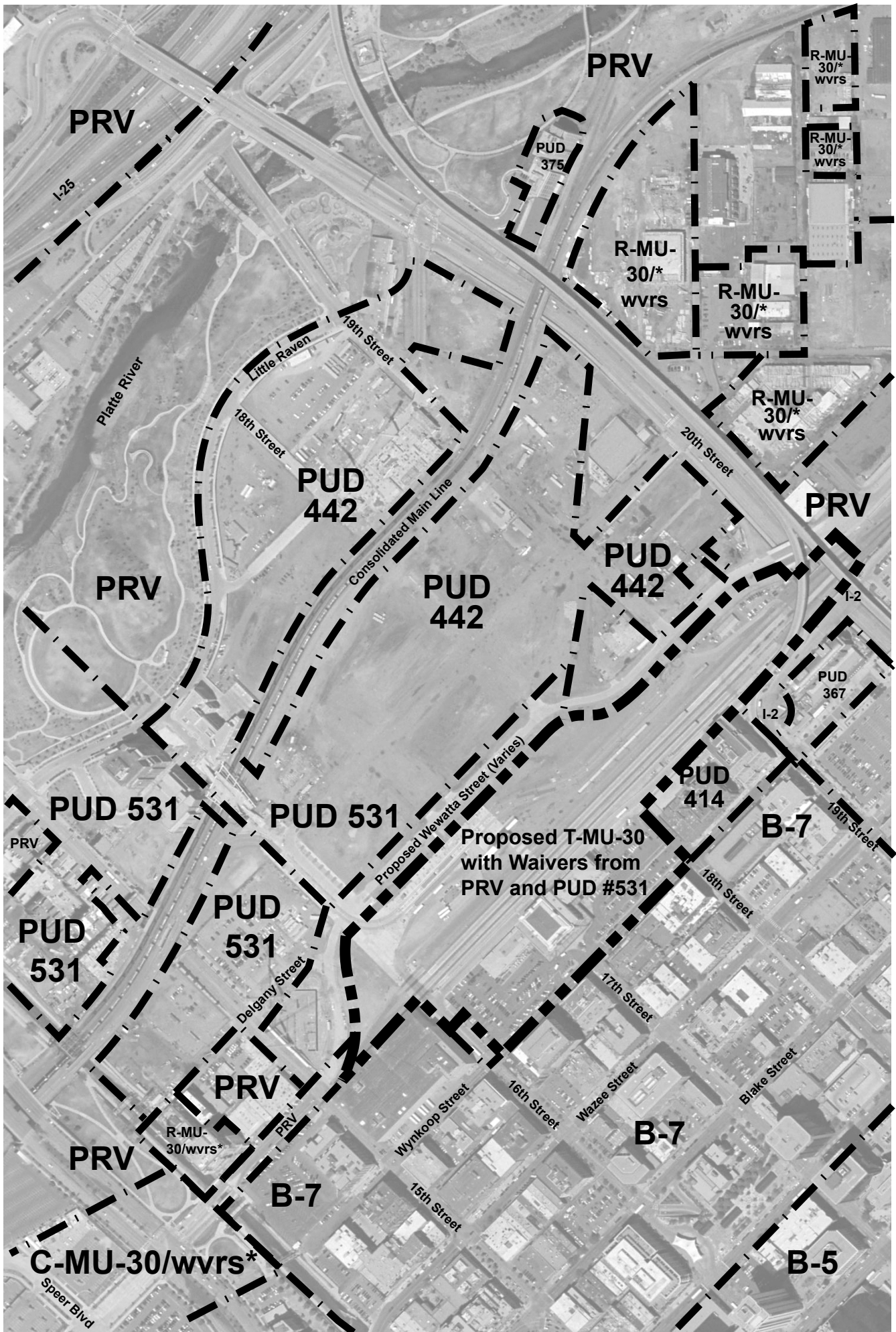

Exhibit "E"